

Transport- and project drawing

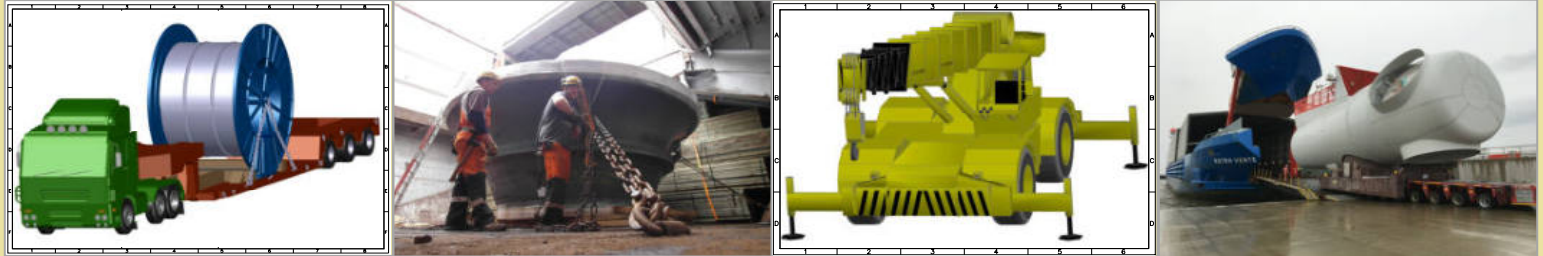

Loading and transport survey

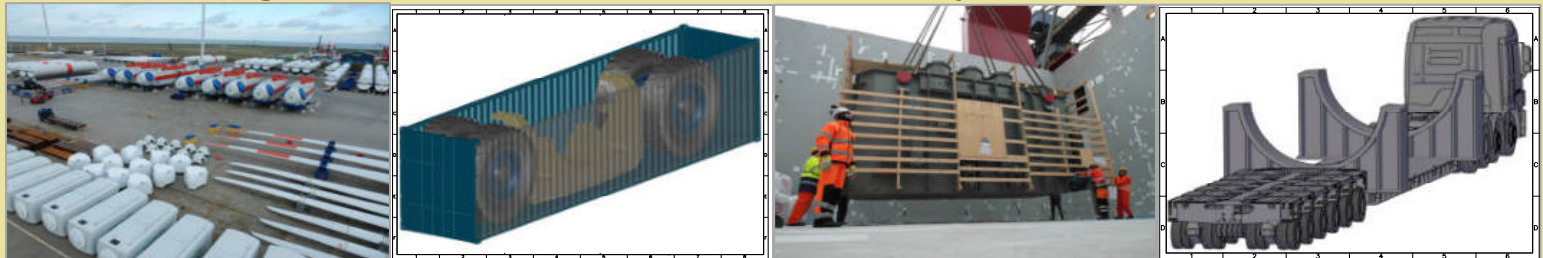

Technical route and accident survey

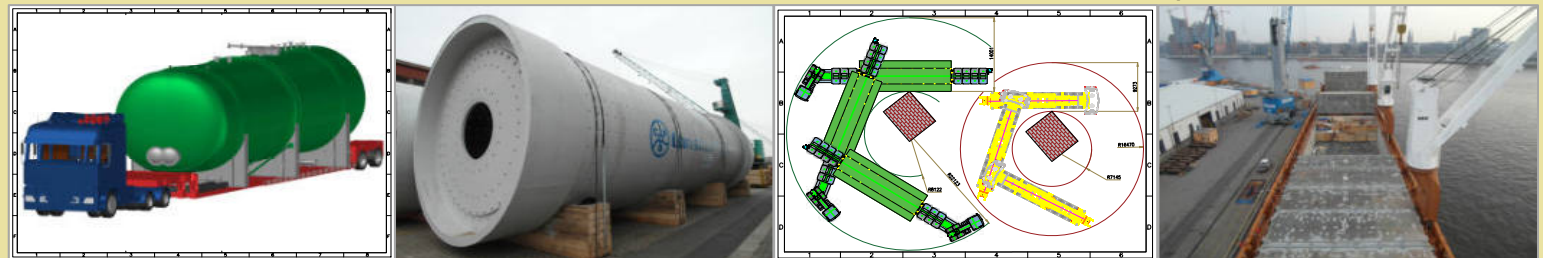

Rendering (computer graphics)

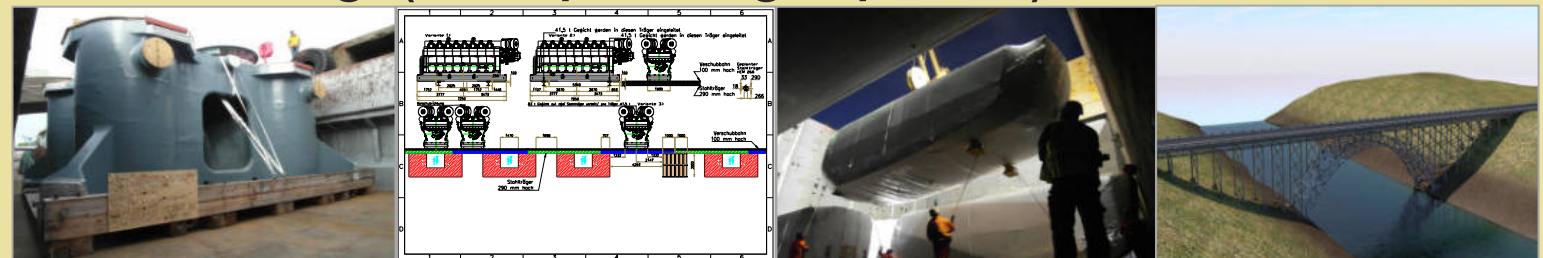

Animation / simulation / tractrix

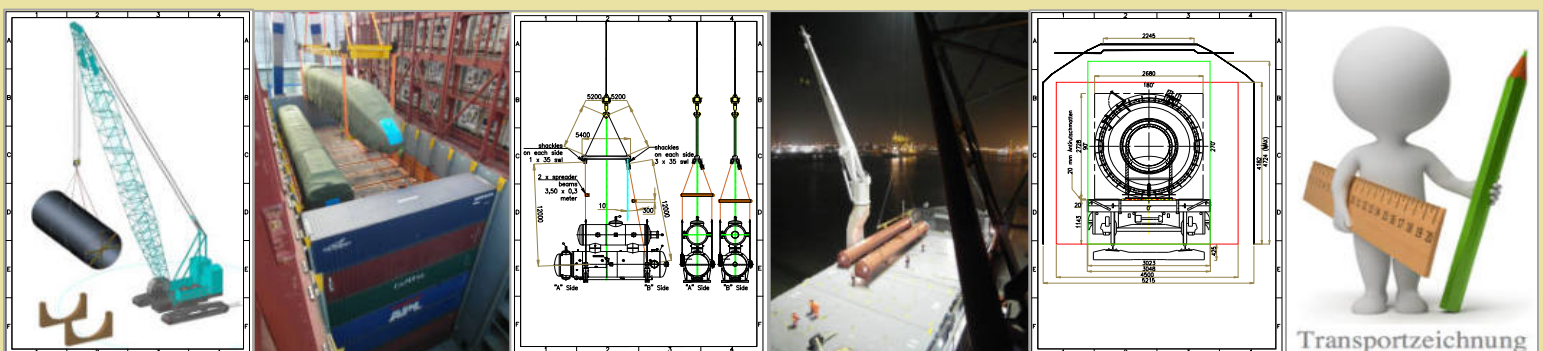

Technical drawings for transport, assembly, installation, constructions and packaging

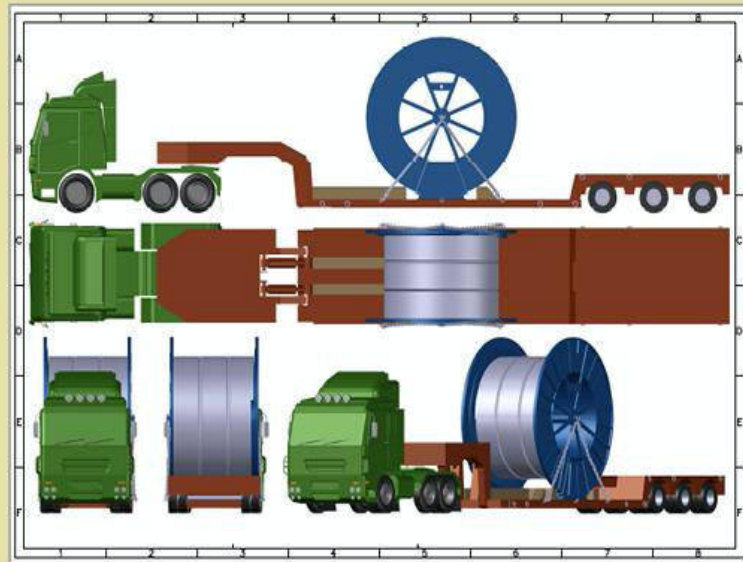

Drawing types

Packaging concepts and stowage plans, assembly and installation plans, stowage optimising, principle drawings, construction plans, presentation drawings, feasibility studies, problem solution drawings, installation plans, transport and project drawings (engineering), communication drawings, warehouse designs, detailed technical drawings for structural analysis and packing lists, warehouse plans, site plans, loading plans, handling scenarios, load distribution scenarios, patent drawings, analytical drawings;

Working topics

Design, drawing and calculation of necessary cargo securing measures on ship, rail and road carriers. We secure your cargo in drawings for any transport and handling equipment you desire, with different views of anti-slip mats, lashing chains, tight fits, supports, wedges, straps, etc. We then calculate the resulting necessities from this. Depiction of procedures involving heavy duty lifting and skidding rail systems during foundation shipment. The technical drawing (visualisation) serves the planning, depiction and implementation of customer wishes.

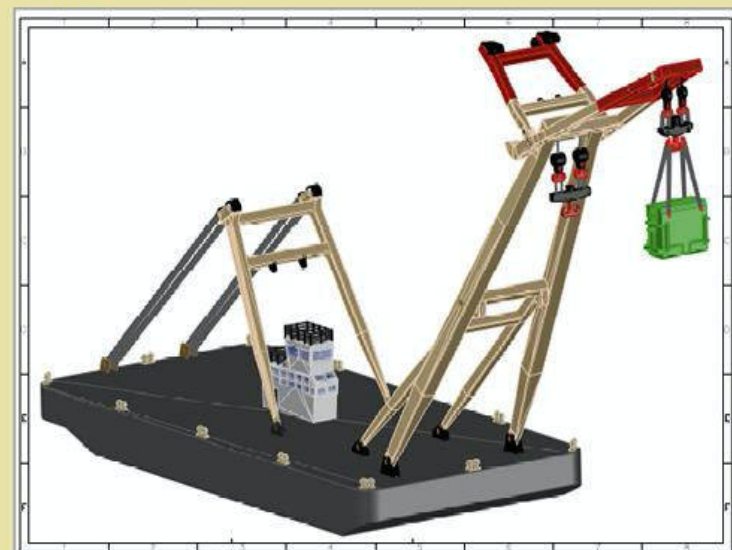

Processes and ideas are illustrated in a generally comprehensible manner through the aid of technical drawings, images and symbols. Technical drawings are a special form of communication.

Furthermore, enormous savings can be achieved in terms of time, risks, money and material through drawings and simulations.

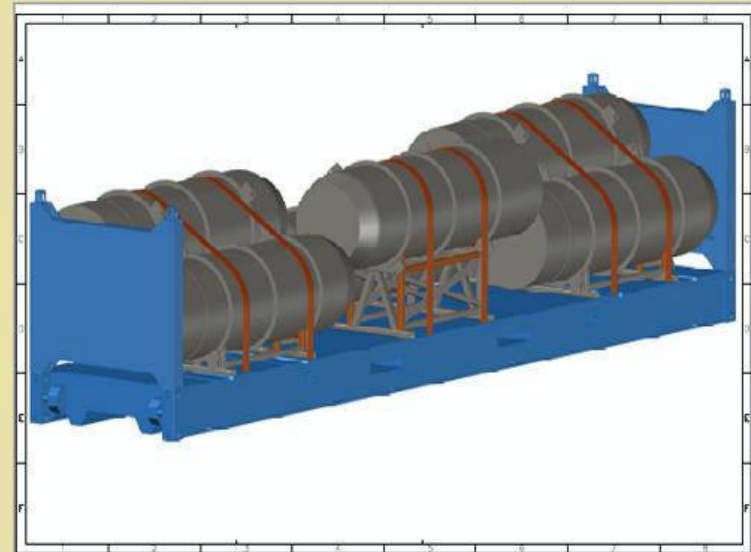

This communication method enables the accessing of information to improve decision-making, reduce conflicts and ensure that projects are concluded quicker.



Aspects such as the shape, size and variants of products and procedures are ordered in a practical manner and made generally comprehensible through standardisation.

A transport drawing (engineering) also goes beyond the scope of commercial order processing when it comes to the graphic illustration of procedures in a realistic manner.

The level of quality and environmental compatibility of contract and transport processing is, consequently, greatly enhanced as a result.



Transportzeichnung
In the beginning there was the line ...

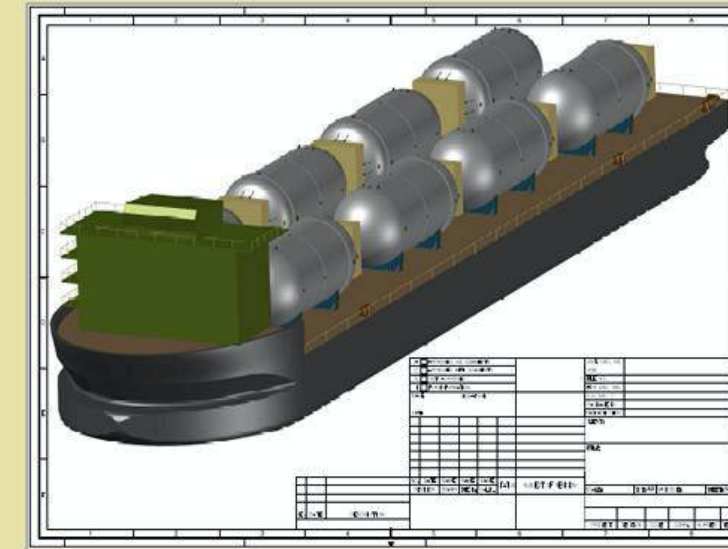

Application areas

- Preliminary planning and professional organisation of your projects
- Pictorial illustration and design of your transport concept
- Visual stimulation of your offers and quotations
- Documentation of your actions, both before and after the work
- Packaging regulations and packaging plans
- Lifting, load and handling regulations
- Compilation of project documentation
- Determining the navigability of local conditions (bridges / ramps / moorings)
- Required slings in the case of cargo whose centre of gravity is not centred relative to the lifting points
- Engineering plans, machine housings
- Depiction of loading and unloading scenarios
- Exact positioning of loading equipment
- Illustration and calculation of necessary cargo securing measures
- Necessity for creating project plans (method statement)
- gantry crane applications, skidding rail systems

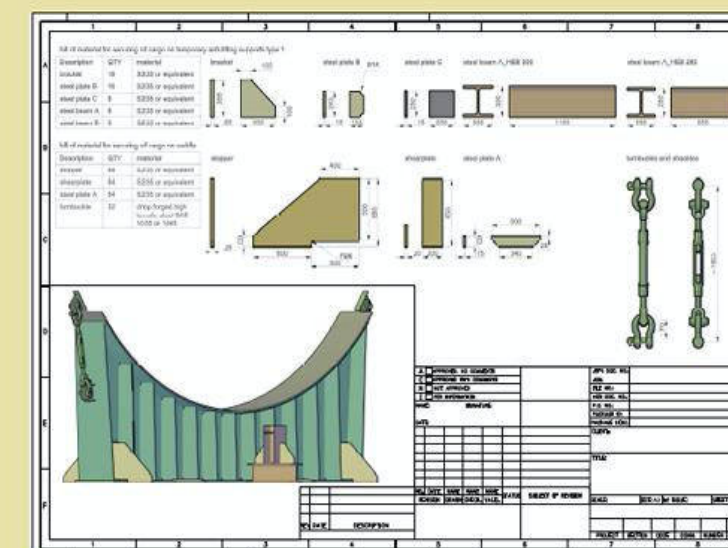

Additionally . . .

The effort involved in the design and creation of drawings is considerably reduced through use of the latest programs.

We work with the very latest programs, and the ability to work quicker means more cost-effective working and drafting of offers.

Valuable time is saved as a result.

Greater productivity is achieved during working hours through the use of state-of-the-art programs and automation of many working steps.

An example of this is the automation of dimensioning and rendering functions.

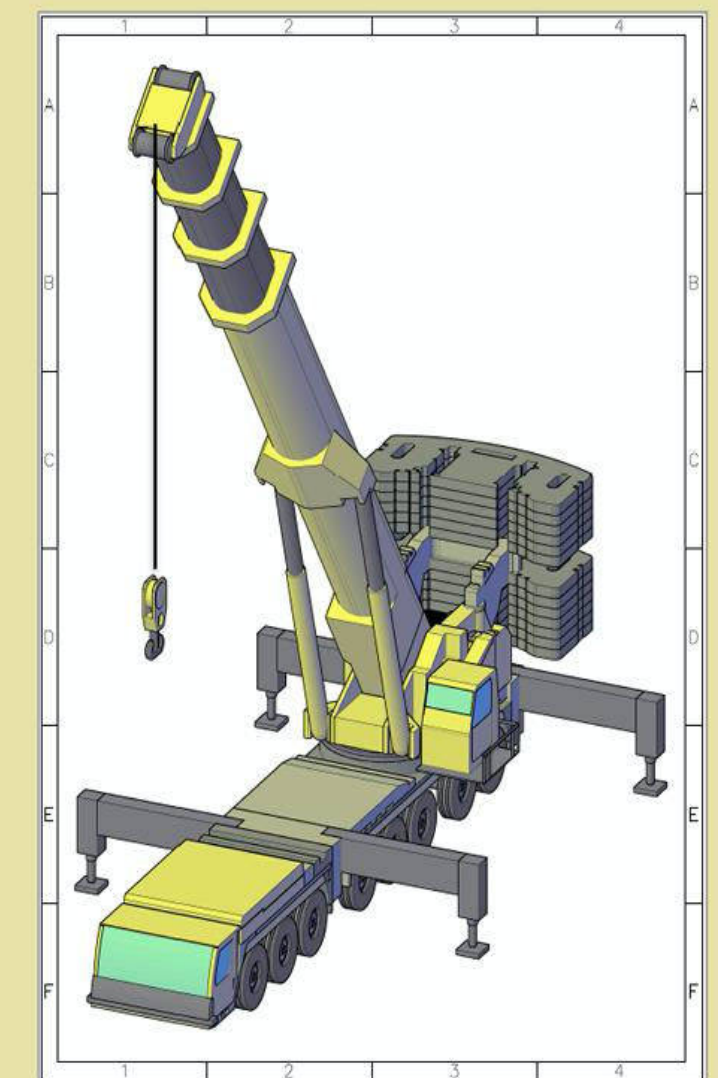

Moreover, regular training measures ensure the optimising of work productivity and performance, all of which benefits our customers.

These types of drawings are frequently required promptly and need to be exact and presentable. A responsible and speedy manner of working is a precondition in this respect.

We work on the principle of close coordination with our customers.

Only so can an attractive, competitive price-performance ratio be offered.



Transportzeichnung
In the beginning there was the line ...

Loading and transport monitoring in ports and production facilities (surveyor/supercargo)



Loading and transport survey is necessary to ensure the smooth transportation of your goods. Delays mainly impact the transport chain. Many years of experience in cargo inspection, loading and cargo securing enable the reduction of delays and, consequently, costs. Cases of damage and the time required to process these can be reduced to a minimum through loading inspections. Further partial shipments and projects optimise processes. Monitoring of loading and inspections of its interfaces with clear documentation contribute to both safeguarding against compensation claims and the warding off of complaints. Monitoring of loading also contributes to work and transport safety. Our local knowledge and contacts in many ports mean that deviations and divergences can in most cases be regulated and controlled on site and during loading itself. We deal with, evaluate and guard your heavy goods and project shipment with regard to local and international aspects and conditions at the shipping location.

Our areas of activity

Goods and packaging inspections

We check prior to loading or in the case of damage to ascertain whether packaging is suitable for the mode of transportation. This preventive inspection saves you the time and money in advance needed to address claims for compensation (recourse) in the recipient country, as these are usually very lengthy and tie up staff.

Tasks to be clarified in advance may include the following:

- Determining the number of packages
- Examination of the external condition of packages
- Checking of regulations (e.g. impregnation of wood / certificates / packing lists)
- Checking of markings: centres of gravity, chain markings, lifting points, bills of lading, handling symbols and markings
- Is the hazardous cargo registered and adequately marked?
- Which deck option is available?
- Are packages sensibly stowed / secured?
- Have the tarpaulins brought also been loaded?
- Are loading gear or crossbeams to remain or be brought with the shipment?
- Weather conditions during loading/ wet before shipment



- Condition of the ship / cargo hold / dry / clean
- Inspection of condition of warehouse or storage location / clean / dry
- Inspection of cargo securing
- Which cargo is still on board the ship?
- Assessment of technical equipment (handling equipment, transport equipment)
- Evaluations, risk analyses, occupational safety
- Inspection of certificates and documents
- Visual inspection of crossbeams and lifting gear to be used (shackles, ropes/cables, chains)
- Inspection of loading, stowage and cargo securing
- Checking of all safety- related aspects



Reporting

Reporting summarises the entire transport process at all critical points through descriptions / sketches / tables / plans and photographic documentation. It serves as verification to refute any recourse claims (claims for compensation) in the event of damage. We can compile the report for you in German/English or Russian.

Compilation of method statements

The method statement is a document that lays down the working procedure and sequence of tasks to ensure occupational safety and the safeguarding of health. It is the outcome of the risk assessment conducted during the task or project and the inspection measures resulting from this. It describes the manner in which individual sections of intended transports are to be mastered in chronological order. The method statement represents an advance concept for the realisation of the task and a risk assessment. Tasks are clearly delegated to all those involved, including in the case of discrepancies (accidents or environmental damage). A detailed and comprehensive method statement is an indispensable component of process documentation.

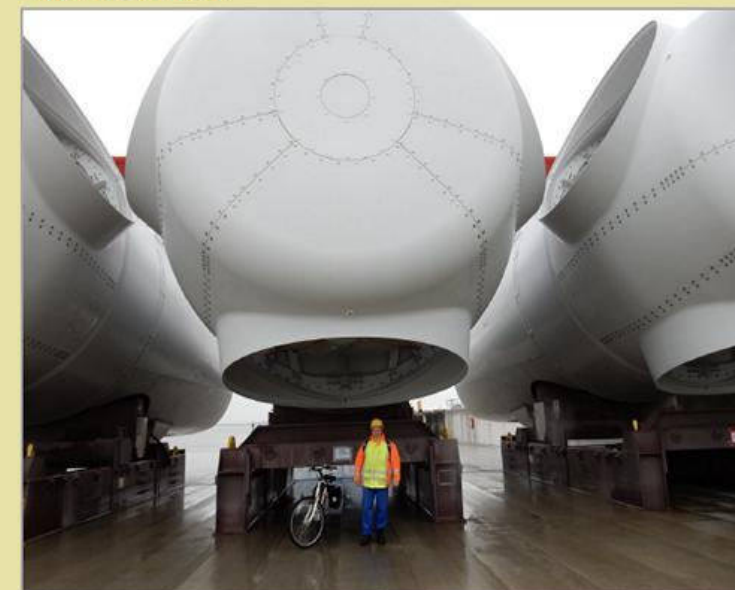

The method statement may contain the following:

- Details of the transport and handling technology to be used
- A description of interfaces and transitions between actions
- Loading and cargo securing measures
- The naming of personnel involved and their responsibilities
- Enumeration of each risk / risk source / risk potential
- Risk assessment - probability of damage actually occurring
- Specification of risk reduction measures
- Safety briefing
- Procedure in the event of deviations and changes or in the case of damage and accidents



Risk assessment

A risk assessment is an evaluation of the risks arising during performance and should be compiled in conjunction with a method statement where, for example, mobile lifting gear is used.



Technical route survey

/

Tractrix

Animation/Simulation/Rendering(computer graphics)

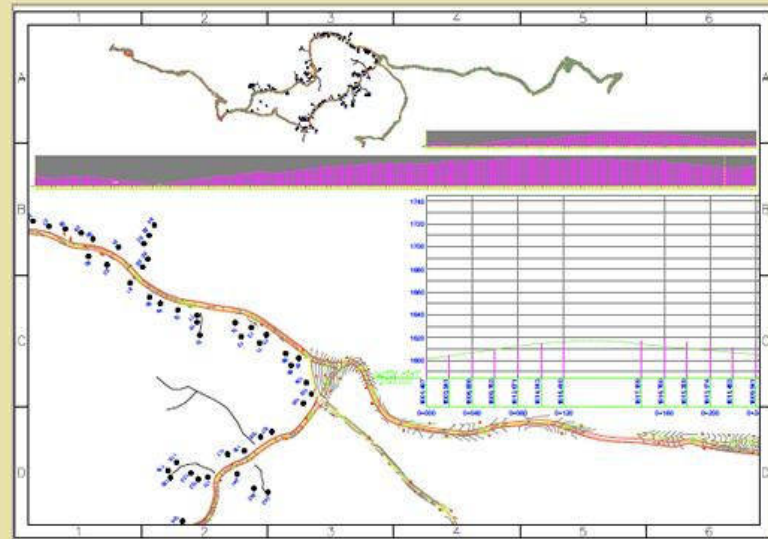
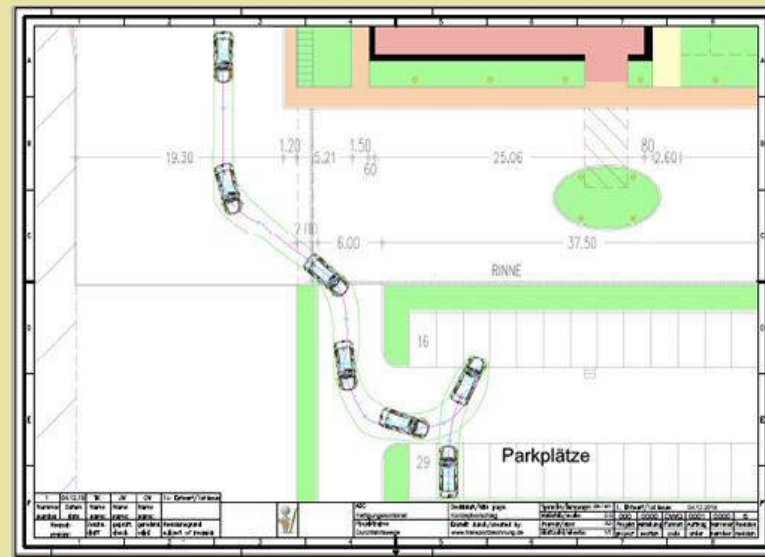
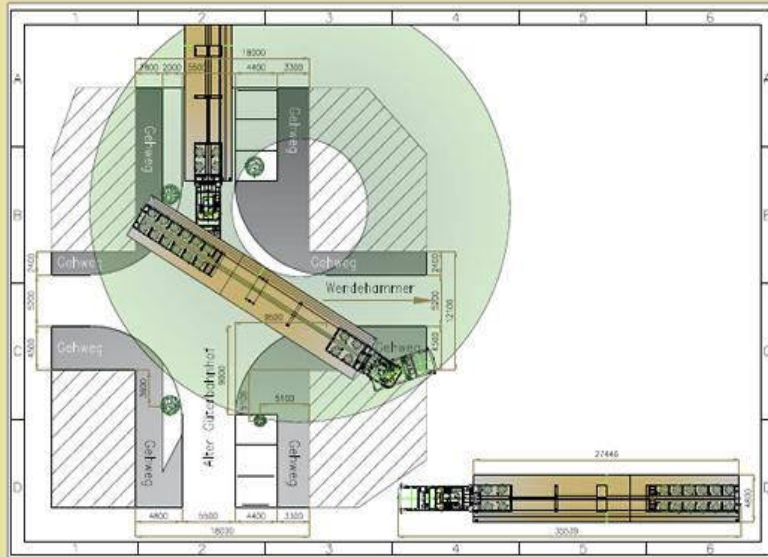

Elevation map

Technical route surveying aids selection of the transport routes on which transports can be realised in compliance with the project transport agreement and individual transport order and determination of whether and to which degree legal approval restraints may be expected.

Knowing in advance whether a transport is feasible allows you to act independently during the offer phase and then flexibly during selection of the transport company to realise the task.

Using tractrix curves, of complex vehicle maneuvers can be reliably tested for passability in 2D/3D or as simulation/animation, roads or other traffic projects. Keywords for the applications:

- curves - roundabout and intersection planning
- vehicle turning simulation and collision check
- parking space management and terrain planning
- ground clearance analysis and encounter check
- port management and airport management
- company premises modeling
- clearance gauge and space dividers
- checking existing planning
- object bypasses as well as visibility check

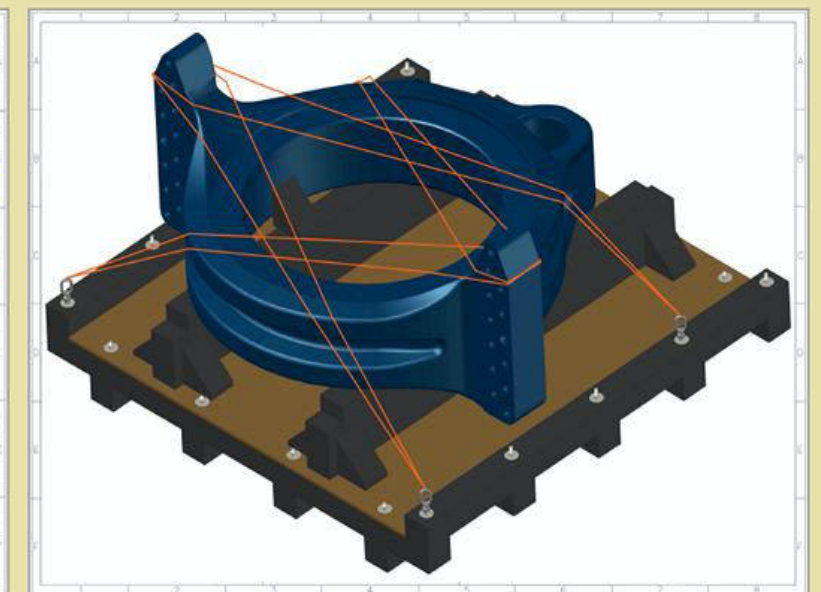

Visualization by animation / simulation helps presenting technical possibilities and also technical boundaries in a new and very natural way. Point cloud processing is also possible.

Smaller examples of simple animations / simulations can be found on our world web page under this link:
http://www.transportzeichnung.de/produkte_en.html





About me

- Transportation engineer
- Leading expert and draftsman with broad experience working in Germany, Ukraine, Russia and Libya
- Logistics manager IHK (Chamber of Industry and Commerce)
- Cutting machine operator (vertical turning and boring mill)
- average agent
- Good connections in ports and manufacturing sites
- Additionally, has a good command of Russian (free speech and writing)

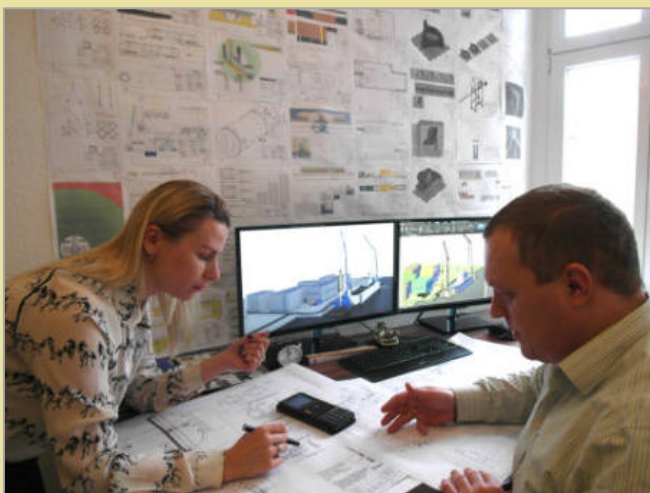

Contact Details

Thomas Krause

Transportzeichnung

Grunowstraße 7 13187 Berlin

Telefon: + 49 030 670 61 972

Fax: + 49 030 670 61 974

mobile number: + 49 176 497 53 956

E Mail: thomas.krause@transportzeichnung.de

www.transportzeichnung.de

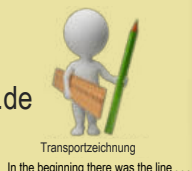

Our principles

- Objective reporting of events, immediate notification of the customer in the event of deviations, immediate notification of those responsible of deficiencies and the arrangement of repairs are a matter of course for us.
- Damage limitation measures are implemented in advance during goods and packaging inspection.
- Exact documentation to ensure later traceability of all circumstances.
- We employ modern and safe methods and can draw upon decades of knowledge and experience
- You receive prompt visual and verbal information at all times.
- This allows decisions to be made without delay and costs to be reduced.

Result of my work

- Responsibility
- Precision
- Quality
- Good value for money

We are supported by a professional team.

We would be more than happy to share our experience in all transport, installation and packaging questions with you.

We also examine the feasibility of independent transport offers.

Please contact us. We like working, and it would be a pleasure to work in your interest.

Many thanks for your attention
Your Transportzeichnung Team

